

Stock Totals Report



This report gives the number and ages of all classes of sheep on your farm.

Use this report to find:

- Total number of sheep on-farm.
- Compare changes in inventory.

1. Go to **Farm Records > Stock Totals**
2. Pick a date in the calendar such as January 1 or December 31.
3. Click **Recalculate** to see the animal inventory.
4. Click **Print Details** to get more detail on the ages of the animals on inventory.

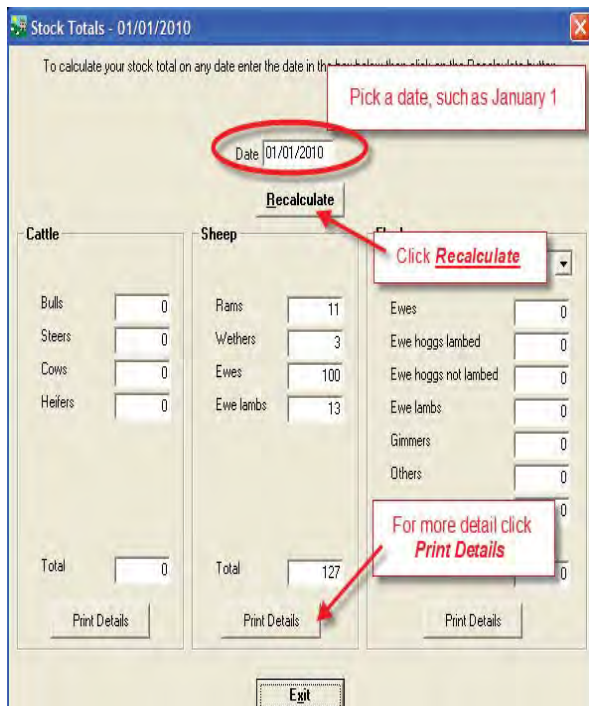
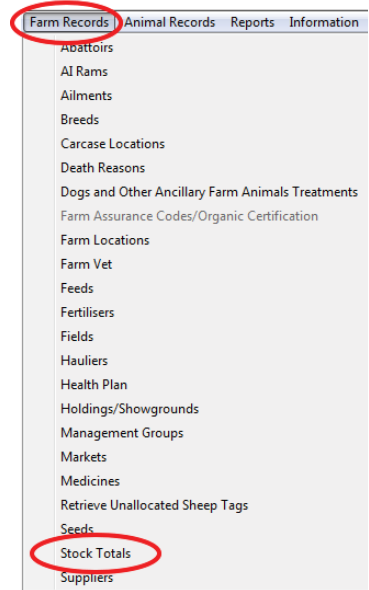

Stock Summary Report for Sheep

Owner: New M
Holding Number:
Holding Name: New M
Date Printed: '

Stock Summary on 14/02/2011

Summary Stock Totals for: Ewes

	Total Breeding	Total Non-Breeding	Total Stock
Under 12 months old	0	0	0
12 months and older	78	0	78
Total in Stock for Ewes:	78	0	78

Summary Stock Totals for: Ewe lambs

	Total Breeding	Total Non-Breeding	Total Stock
Under 12 months old	0	8	8
12 months and older	0	0	0
Total in Stock for Ewe lambs:	0	8	8

Summary Stock Totals for: Rams

	Total Breeding	Total Non-Breeding	Total Stock
Under 12 months old	0	0	0
12 months and older	6	0	6
Total in Stock for Rams:	6	0	6

Careful! Inventory includes sheep that are recorded as missing, plus any that have been sent to market or slaughter but the sale details haven't been recorded yet. Clean up those loose ends or this report will not be as accurate as possible.